



Paulmann

Safety Instructions

1, 2, 10, 12, 16, 34



Info

www.paulmann.com

Paulmann Licht GmbH
Quezinger Feld 2
31832 Springe
Germany

www.paulmann.com

Art.-Nr.: 942.11
(+MA 326) PLI 03/18

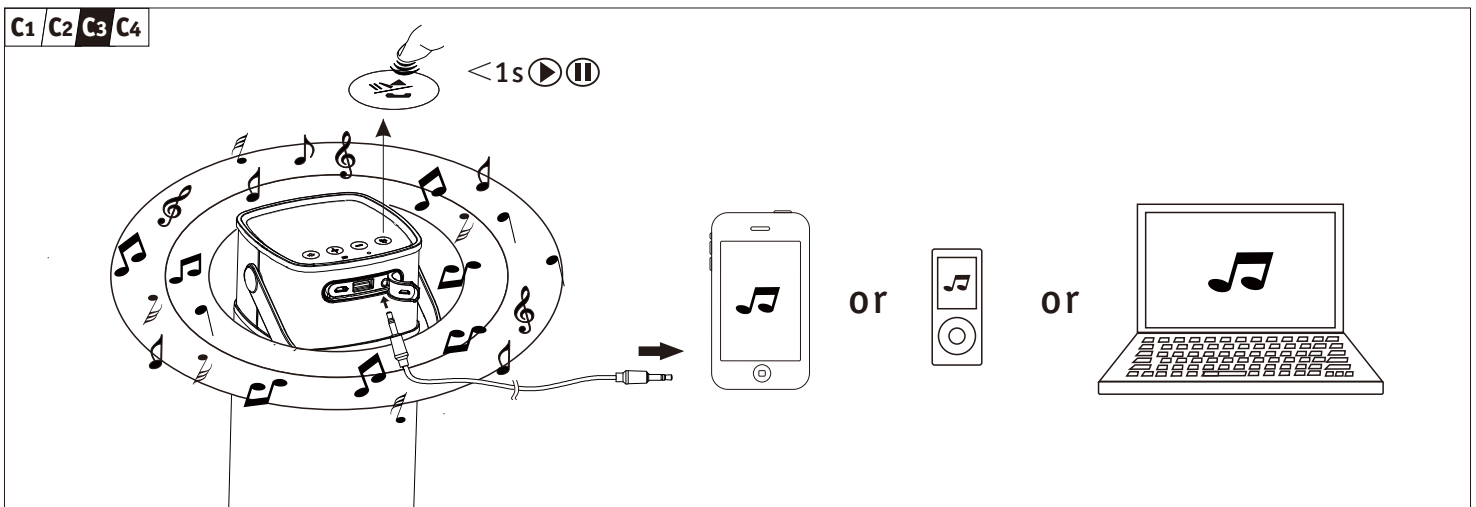
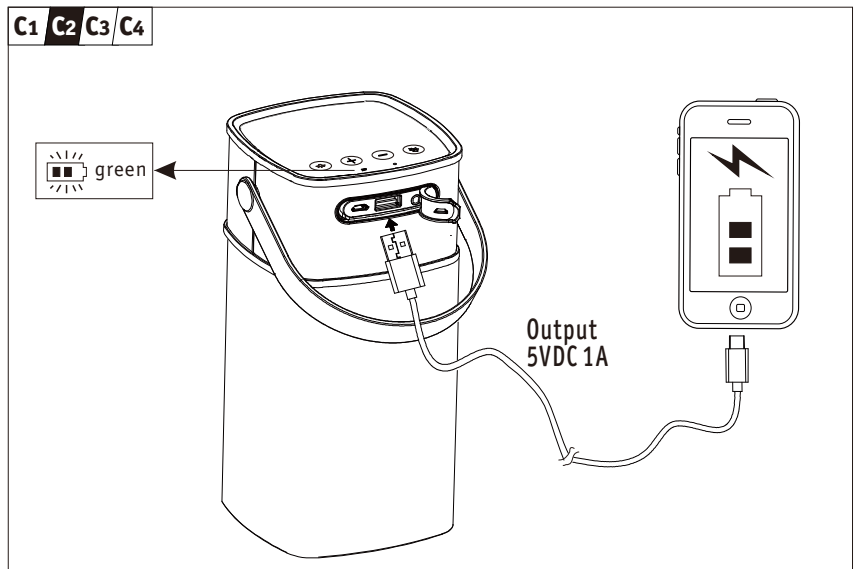
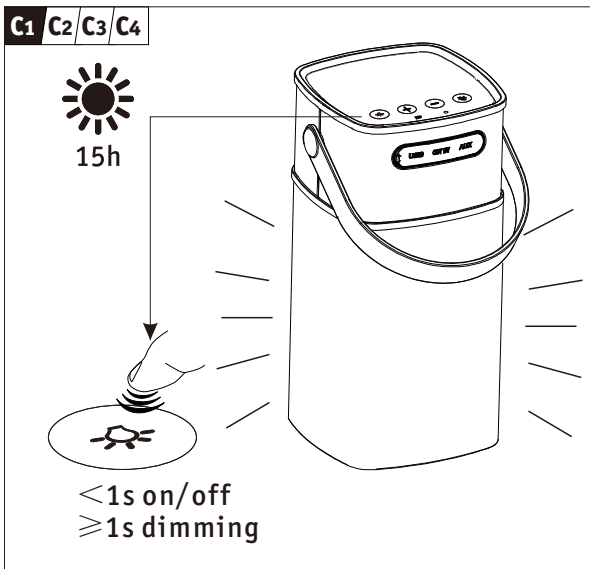
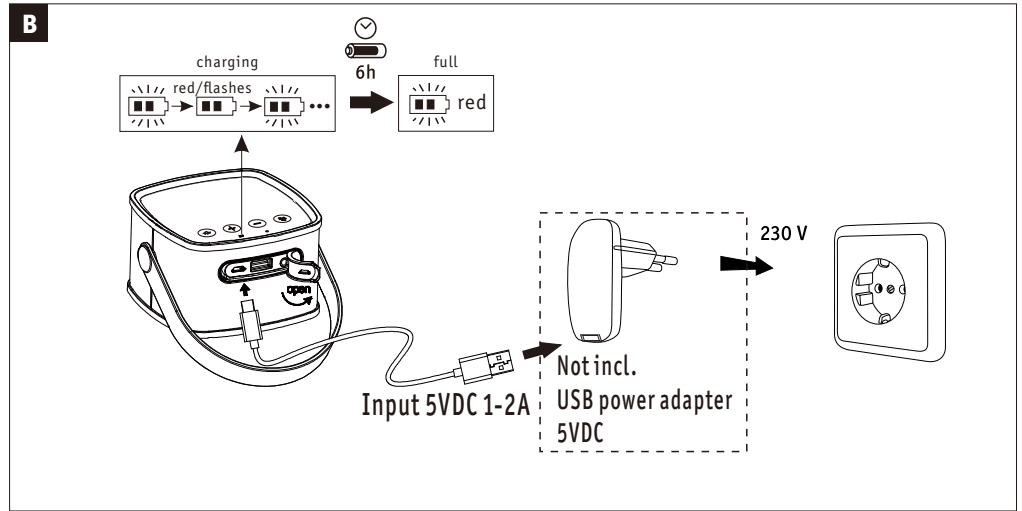
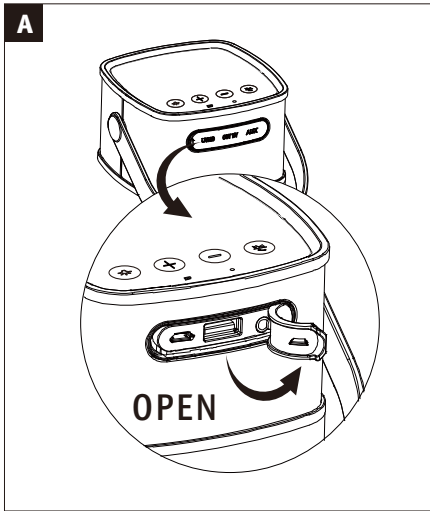
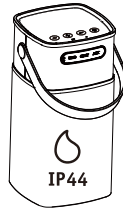

C1 C2 C3 C4

Bluetooth

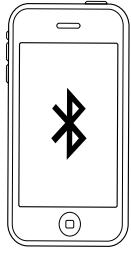

Max 10m

signal " PAULMANN"

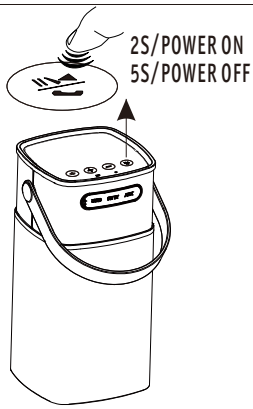

2S/POWER ON
5S/POWER OFF

D1 D2

Speakerphone

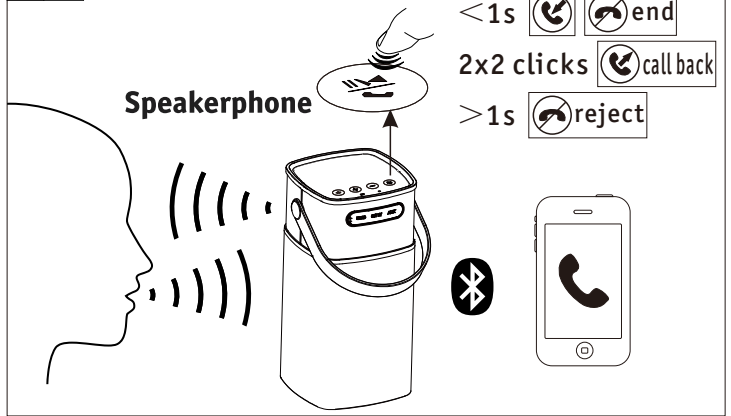

- < 1s end
- 2x2 clicks call back
- > 1s reject

D1 D2

16h

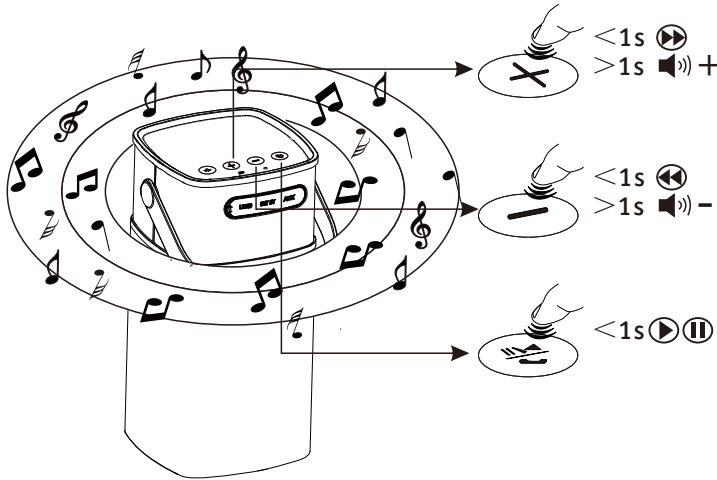

- < 1s +
- > 1s -

- < 1s -
- > 1s -

- < 1s

Zugelassen für den Betrieb in allen Ländern der EU / Approved for operating in all European countries

CE: Konform mit / in accordance with / conformement a 2014/30/EU, 2014/53/EU <http://www.paulmann.com/de/de/b2b-haendler-log-in.html>

2,4 GHz - 2,4835 GHz



NO

doesn't apply for the geographical area within a radius of 20km from the centre on "Ny Alesund"

Funk-Frequenz [2402MHz~2480MHz]
Abgestrahlte Energie [10mW]